

McKinney PAC Meeting – Minutes

December 2, 2024 at McKinney School / Teams

Welcome	7:07 pm – Call to Order
Meeting Attendees:	Ivy Ho, Heather McEachern, Angel Hsu, Norman Chow, Eileen Fujimuro, Cheryl Neufeld, Tara Caffrey, Anita Sandhu, Sunny Song
McKinney Administrators:	Gallit Zvi, Monika Sood
Adoption of Agenda	<p>We would like to begin by acknowledging that the land on which we gather is the unceded territory of the heñ q̄ emiñ əm speaking people.</p> <p>Agenda was adopted as presented. Moved by Norman, second by Eileen. Motion passed.</p>
Chair Update: Anita	<ul style="list-style-type: none">– Playground Update<ul style="list-style-type: none">▪ Dave Warner from Habitat Systems presented designs for new playground.▪ Dave has been at Habitat for 25 years and Habitat has worked with Landscape Structures for over 25 years.▪ Habitat Systems has installed playgrounds at many parks including South Arm Park in Richmond and Unwin Park in Surrey.▪ For McKinney’s design, the new playground site is located beside the existing basketball court, bounded by the existing hockey court and picnic tables.▪ The designs are based on a budget of \$60,000 for equipment and installation, and assumes that SD38 Facilities will prepare the site and provide borders and wood fiber safety surfacing.▪ The designs incorporate natural play elements and climbing and spinning pieces that encourage vestibular stimulation (i.e. sense of balance).▪ Playground Design 10698-1-1 incorporates the following elements:<ul style="list-style-type: none">◆ Texada Log Climber – Habitat’s largest log structure, 9 logs, each log is 12 feet long and 12-14 inches diameter, occupies about 32 feet x 36 feet area, 3 levels of logs, good for balance, agility, unstructured play, and can function as an outdoor classroom, installed at South Arm.◆ TopsyTurny Spinner – good for cooperative play and primary kids, some kids can be on spinner, other kids can turn the piece, installed at several Richmond schools.◆ Chill Spinner – kids can sit and take their time, have quiet time, or have cooperative play with other kids spinning them, one installed at South Arm.◆ Sky Rail Climber – challenging climber, good alternative to the Spacenet Climbing Pyramid.◆ About \$55,000.◆ See design attached.

McKinney PAC Meeting – Minutes

- Playground Design 10698-2-1 incorporates the following elements:
 - ◆ Cortes Log Climber – Habitat’s second largest log structure, lower cost than the Texada log climber, 7 logs, occupies about 28 feet x 28 feet area, 3 levels of logs.
 - ◆ Boogie Board – multi-use piece, good for swinging, hanging out, cooperative play, very popular piece, installed at Thompson Elementary.
 - ◆ OmniSpin Spinner – good for children of all abilities, inclusive play, “today’s merry-go-round”, installed at Whiteside Elementary.
 - ◆ Chill Spinner – described above.
 - ◆ Curva Spinner – stand up, multi-use spinner, installed at Westwind Elementary.
 - ◆ Saddle Spinner – accessible spinner, children can get on themselves and hold on, installed at Dolphin Park.
 - ◆ About \$60,000.
 - ◆ See design attached.
- Q&As
 - ◆ Would the OmniSpin Spinner fill with rainwater?
It has drain holes and is designed to withstand the elements.
 - ◆ What is the longevity of the Boogie Board?
Made from very thick material, like a conveyor belt, extremely robust, very durable.
 - ◆ What is the longevity of the log climbers?
Made from yellow cedar, BC natural wood, installed on the vertical making them less susceptible to water and rot.
 - ◆ What is the warranty of the playground?
Natural play elements are warranted for 1 year, Landscape Structures are warranted from 3 yrs to 100 yrs depending on the piece.
 - ◆ Can elements from the two designs be mixed and matched?
Yes, mix and match elements based on preference. Habitat can update design.
 - ◆ Can Habitat supply the Pebble Harp?
No, recommend purchasing from the Pebble Harb manufacturer.
 - ◆ Does Habitat build wooden pergolas?
Habitat installed pergolas at Thompson Elementary, quite costly, recommend PAC to discuss with Facilities.
 - ◆ Which surface will be used – wood fibre or poured rubber?
Wood fiber. Poured rubber is quite costly, about \$40 per square feet.
- Discussed the decision to use the space beside the existing basketball court, main reason was because the site is within the sightline of monitors.
- Discussed expediting decision and submission to Facilities, aiming to be first school in line for site preparation and spring install.

McKinney PAC Meeting – Minutes

	<ul style="list-style-type: none"> ▪ Discussed sharing playground options with students and asking for their preferences. <ul style="list-style-type: none"> ◆ Tara will create a survey asking students and families to rank the playground pieces in the order that they want most at McKinney. ◆ Email to families should acknowledge that the amount raised was not enough for the Spacenet Climbing Pyramid. ▪ Discussed payment and deposits. <ul style="list-style-type: none"> ◆ PAC will open and transfer funds into a playground account, Facilities makes purchase and draws funds from the playground account. ▪ Discussed \$5,000 playground grant from Western Insurance, winner is selected by random draw. Hope to hear results in the coming weeks. - Movie Night - Thursday January 16, 2025 <ul style="list-style-type: none"> ▪ Last movie night under the current movie license. ▪ Send movie suggestions to Tara. ▪ Anita will be away, will need a volunteer to prepare bins with labels so kids can vote. Put bins out first week back from school. ▪ Sunny to setup Munchalunch for pre-ordering. ▪ Final day of voting will be Monday, January 13. ▪ Discussed whether to renew the movie license. <ul style="list-style-type: none"> • \$460 revenue from November 15 movie night; it was not as popular as the first movie night, but still a good source of revenue. • Take a break and revisit purchasing license in April 2025. - Winter Wonderland Skate – December 19, 5:00 pm to 6:30 pm <ul style="list-style-type: none"> ▪ Booked and paid. - Code Ninja <ul style="list-style-type: none"> ▪ Local business in the Brighthouse area. ▪ Owner, Jeff Kam, can provide discounts to all McKinney students. ▪ Discussed whether to include in PAC newsletter. PAC agreed not to include.
<p>Administrator’s Report: Gallit</p>	<ul style="list-style-type: none"> - Stream of Dreams <ul style="list-style-type: none"> ▪ No update yet on the grant selection. - Scheduled Art Starts, How the Raven Stole the Sun <ul style="list-style-type: none"> ▪ Presented by 3 Crows Productions. ▪ \$1,000 plus tax, school will cover the cost. - Bollywood Dance – March 3 to 6, 2025 <ul style="list-style-type: none"> ▪ Students will learn choreography over 4 days and perform on March 7. ▪ Performance will be done in groups, invitations to parents will be sent closer to the date. ▪ \$4,305 plus tax.

McKinney PAC Meeting – Minutes

Treasurer’s Report: Eileen	<u>General Account</u> <ul style="list-style-type: none"> – \$8,300 expenses and \$2,395 revenue for food days. – \$424 revenue from Sun-Oka Apple Fundraiser. – \$459.56 revenue from November 15 movie night. <u>Gaming Account</u> <ul style="list-style-type: none"> – \$711 expenses for Winter Wonderland Family Skate.
Food Days Coordinator: Sunny	<ul style="list-style-type: none"> – All going well. No issues.
Fruit and Veggie Program: Sunny	<ul style="list-style-type: none"> – All going well. No issues.
Social Media Liaison: Cheryl	<ul style="list-style-type: none"> – All going well. No issues.
Other Business	<ul style="list-style-type: none"> – Sun-Oka Apple Fundraiser <ul style="list-style-type: none"> ▪ Winter Campaign runs from November 22 to December 11. ▪ Apples will be delivered on Wednesday, December 18. <ul style="list-style-type: none"> • Driver calls Norman in the morning. • Monika/Helen will direct the driver to the lay down area and the custodian will sort them in the staff room. • Norman will schedule parents to pick up from 2:50 to 3:15, won’t need more than 2 volunteers. – Purdys Fundraiser <ul style="list-style-type: none"> ▪ Orders have arrived and are currently stored at the school. ▪ Tara has volunteers for sorting on December 4. ▪ Parents will pick up on December 5. – Spirit Wear Orders <ul style="list-style-type: none"> ▪ Last day to order is Sunday, December 8. ▪ Norman requested a garment rack, single-level, with wheels. Cost is \$29.99 before tax at Canadian Tire. ▪ Motion by Anita to purchase a garment rack for Spirit Wear size samples using miscellaneous funds. Seconded by Tara. Motion passed unanimously. ▪ V-necks and sweat pants have been requested as future options. PAC plans to hold a Spring Collection in March 2025.
Adjournment at 8:34 pm	Next Meeting on Monday, January 13, 2025, at 7:00 pm.
Summary of Actions	<input type="checkbox"/> Tara: Create playground survey and send to Gallit/Monika for distribution.

THIS PLAY AREA & PLAY EQUIPMENT IS
DESIGNED FOR AGES 5-12
UNLESS OTHERWISE NOTED ON PLAN.



THE USE AND LAYOUT OF THESE COMPONENTS
CONFORM TO THE CANADIAN STANDARDS
ASSOCIATION (CSA) STANDARD CAN/CSA-2614



THE PLAY COMPONENTS IDENTIFIED ON THIS PLAN
ARE IPEMA CERTIFIED (UNLESS OTHERWISE NOTED).
TO VERIFY PRODUCT CERTIFICATION VISIT
WWW.IPEMA.ORG

THIS CONCEPTUAL PLAN WAS BASED ON
INFORMATION AVAILABLE TO US. PRIOR TO
CONSTRUCTION, DETAILED SITE INFORMATION
INCLUDING SITE DIMENSIONS, TOPOGRAPHY, EXISTING
UTILITIES, SOIL CONDITIONS, AND DRAINAGE
SOLUTIONS SHOULD BE OBTAINED, EVALUATED, &
UTILIZED IN THE FINAL DESIGN. PLEASE VERIFY ALL
DIMENSIONS OF PLAY AREA, SIZE, ORIENTATION, AND
LOCATION OF ALL EXISTING UTILITIES, EQUIPMENT,
AND SITE FURNISHINGS PRIOR TO ORDERING. SLIDES
SHOULD NOT FACE THE HOT AFTERNOON SUN.

CHOOSE A PROTECTIVE SURFACING MATERIAL THAT
HAS A CRITICAL HEIGHT VALUE TO MEET THE
MAXIMUM FALL HEIGHT FOR THE EQUIPMENT (REF.
CSA -2614 STANDARD CONSUMER SAFETY
PERFORMANCE SPECIFICATION FOR PLAYGROUND
EQUIPMENT FOR PUBLIC USE, CLAUSE 10.1 CURRENT
REVISION). THE SUBSURFACE MUST BE WELL
DRAINED. IF THE SOIL DOES NOT DRAIN NATURALLY
IT MUST BE TILED OR SLOPED 1/8" TO 1/4" PER
FOOT TO A STORM SEWER OR A "FRENCH DRAIN".

ACCESSIBLE/PROTECTIVE
LOOSE FILL MATERIAL
(ENGINEERED WOOD FIBER SUGGESTED)

REVISION NOTES

DESIGNED BY:

CW
COPYRIGHT: 11/29/24
HABITAT SYSTEMS INC.
3762 NAPIER ST.
BURNABY, BC V5C 3E5
PH: 1-866-422-4828



LANDSCAPE STRUCTURES, INC.
601 7th STREET SOUTH - P.O. BOX 198
DELANO, MINNESOTA 55328
PH: 1-800-328-0035 FAX: 1-763-972-6091

Date	Previous Drawing #	Initials

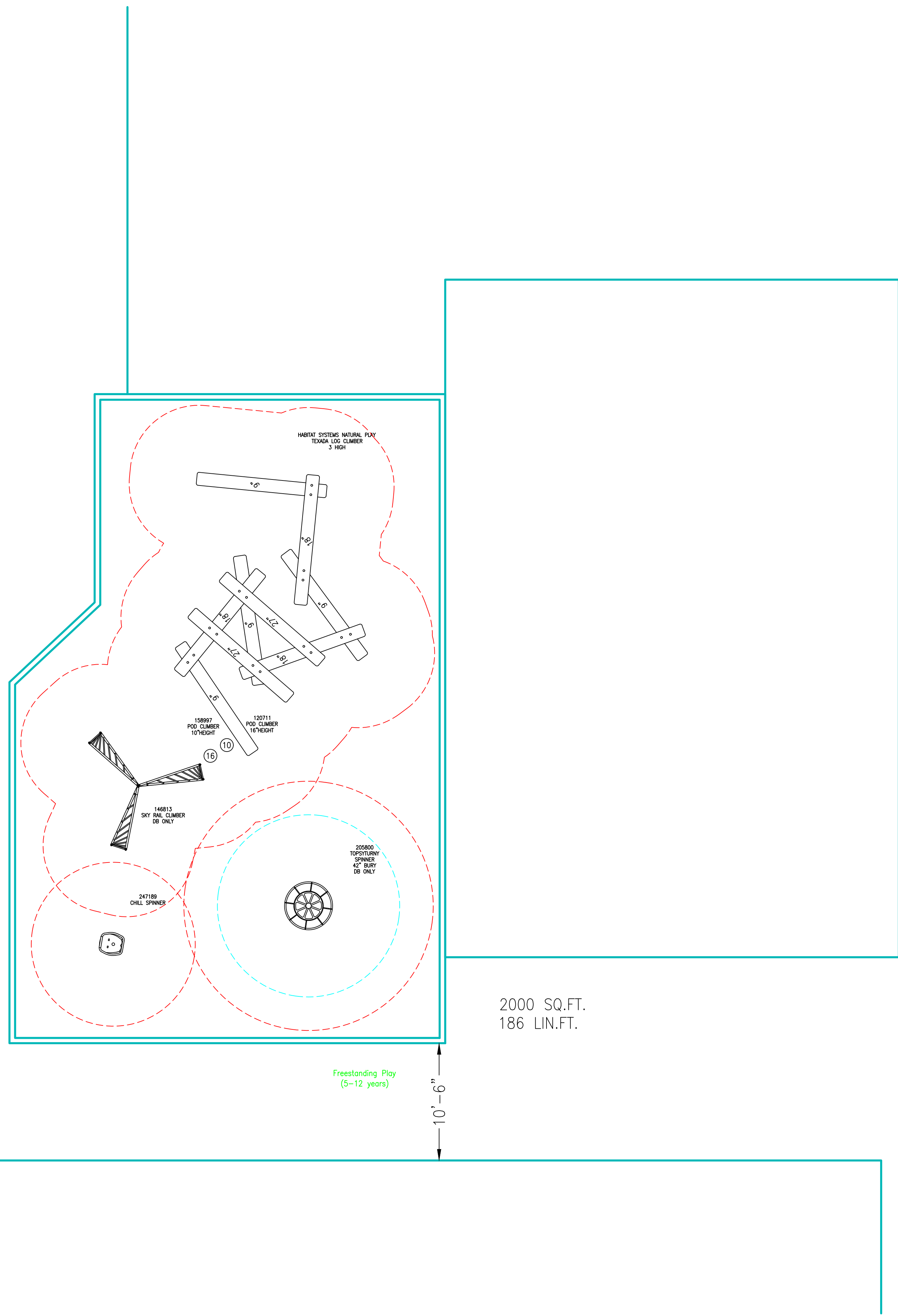

2000 SQ.FT.
186 LIN.FT.

Freestanding Play
(5-12 years)

10'-6"

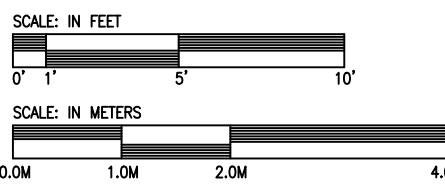
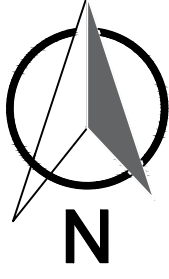

McKinney Elementary
Richmond, BC

Habitat Systems Inc.
Derek Laforest

SYSTEM TYPE:
PlayBooster
DRAWING #:
10698-1-1



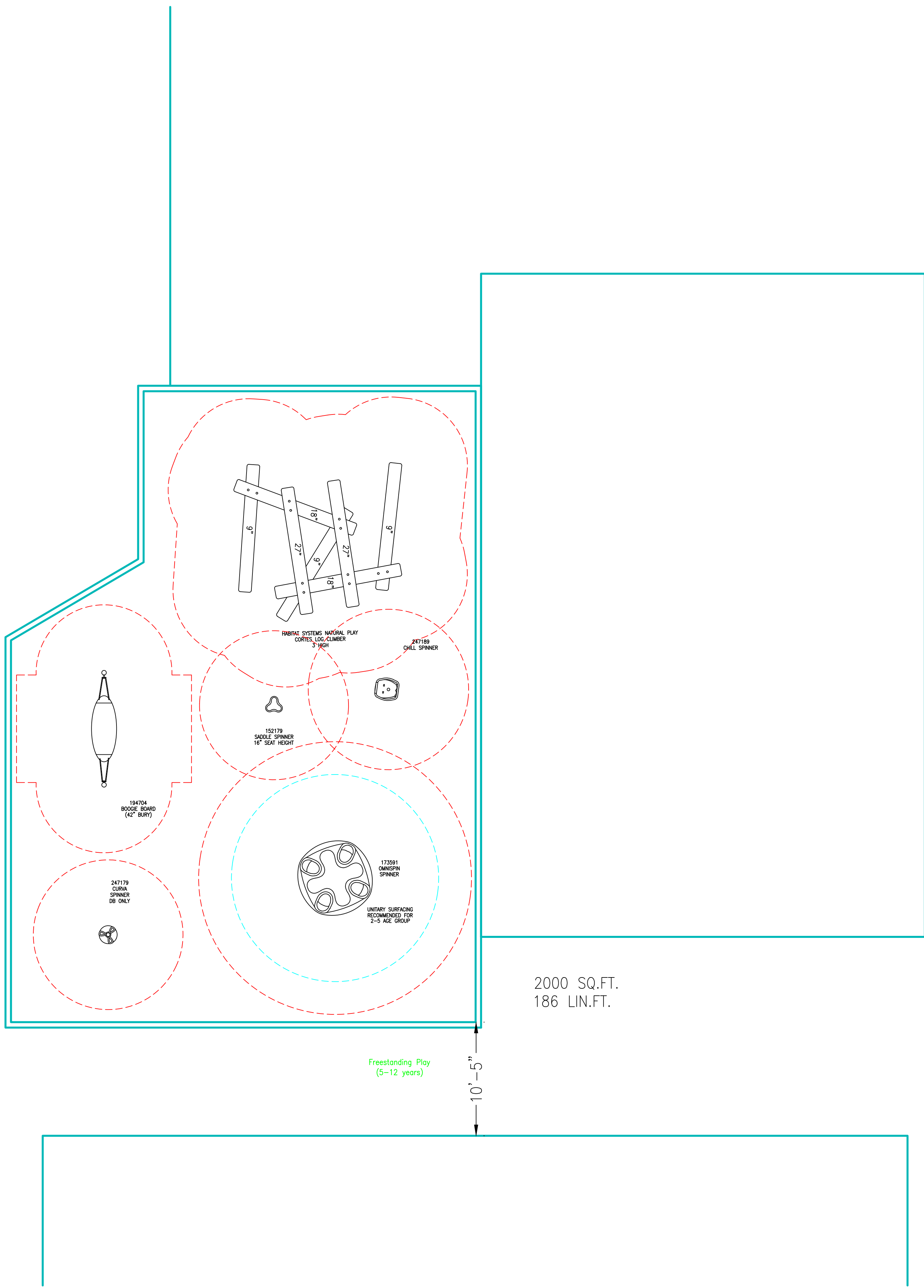

Freestanding Play
(5-12 years)

10'-5"

2000 SQ.FT.
186 LIN.FT.



THIS PLAY AREA & PLAY EQUIPMENT IS DESIGNED FOR AGES 5-12 UNLESS OTHERWISE NOTED ON PLAN.



THE USE AND LAYOUT OF THESE COMPONENTS CONFORM TO THE CANADIAN STANDARDS ASSOCIATION (CSA) STANDARD CAN/CSA-2614



THE PLAY COMPONENTS IDENTIFIED ON THIS PLAN ARE IPEMA CERTIFIED (UNLESS OTHERWISE NOTED). TO VERIFY PRODUCT CERTIFICATION VISIT WWW.IPEMA.ORG

THIS CONCEPTUAL PLAN WAS BASED ON INFORMATION AVAILABLE TO US. PRIOR TO CONSTRUCTION, DETAILED SITE INFORMATION INCLUDING SITE DIMENSIONS, TOPOGRAPHY, EXISTING UTILITIES, SOIL CONDITIONS, AND DRAINAGE SOLUTIONS SHOULD BE OBTAINED, EVALUATED, & UTILIZED IN THE FINAL DESIGN. PLEASE VERIFY ALL DIMENSIONS OF PLAY AREA, SIZE, ORIENTATION, AND LOCATION OF ALL EXISTING UTILITIES, EQUIPMENT, AND SITE FURNISHINGS PRIOR TO ORDERING. SLIDES SHOULD NOT FACE THE HOT AFTERNOON SUN.

CHOOSE A PROTECTIVE SURFACING MATERIAL THAT HAS A CRITICAL HEIGHT VALUE TO MEET THE MAXIMUM FALL HEIGHT FOR THE EQUIPMENT (REF. CSA-2614 STANDARD CONSUMER SAFETY PERFORMANCE SPECIFICATION FOR PLAYGROUND EQUIPMENT FOR PUBLIC USE, CLAUSE 10.1 CURRENT REVISION). THE SUBSURFACE MUST BE WELL DRAINED. IF THE SOIL DOES NOT DRAIN NATURALLY IT MUST BE TILED OR SLOPED 1/8" TO 1/4" PER FOOT TO A STORM SEWER OR A "FRENCH DRAIN".

ACCESSIBLE/PROTECTIVE LOOSE FILL MATERIAL (ENGINEERED WOOD FIBER SUGGESTED)

REVISION NOTES

DESIGNED BY:
CW
COPYRIGHT: 11/29/24
HABITAT SYSTEMS INC.
3762 NAPIER ST.
BURNABY, BC V5C 3E5
PH: 1-866-422-4828

LS
landscape structures
LANDSCAPE STRUCTURES, INC.
601 7th STREET SOUTH - P.O. BOX 198
DELANO, MINNESOTA 55328
PH: 1-800-328-0035 FAX: 1-763-972-6091

Date	Previous Drawing #	Initials

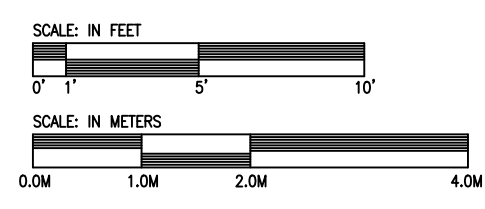
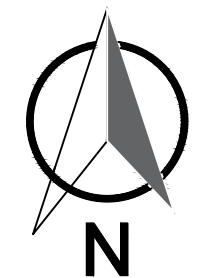

McKinney Elementary
Richmond, BC

Habitat Systems Inc.
Derek Laforest

SYSTEM TYPE:
PlayBooster
DRAWING #:
10698-2-1

